

Übersicht Verbinder + Nuten (Massstab 1:1) / Overview of connectors + grooves (scale 1:1)

Original Holzlamelle 20 /
Original wood biscuit 20

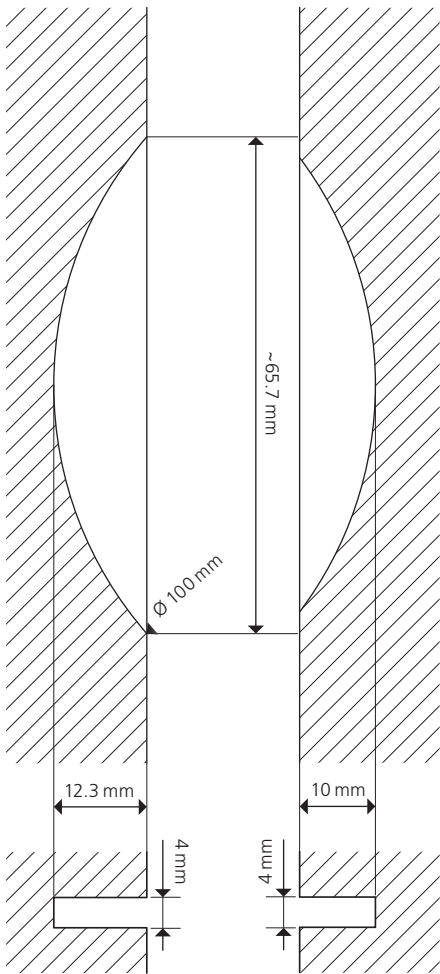
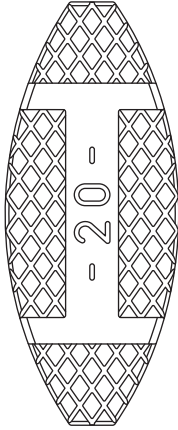

Zugfestigkeit (N)
Tensile strength (N)

Abhängig vom Klebstoff
Depending on the adhesive

Original Holzlamelle 10 /
Original wood biscuit 10

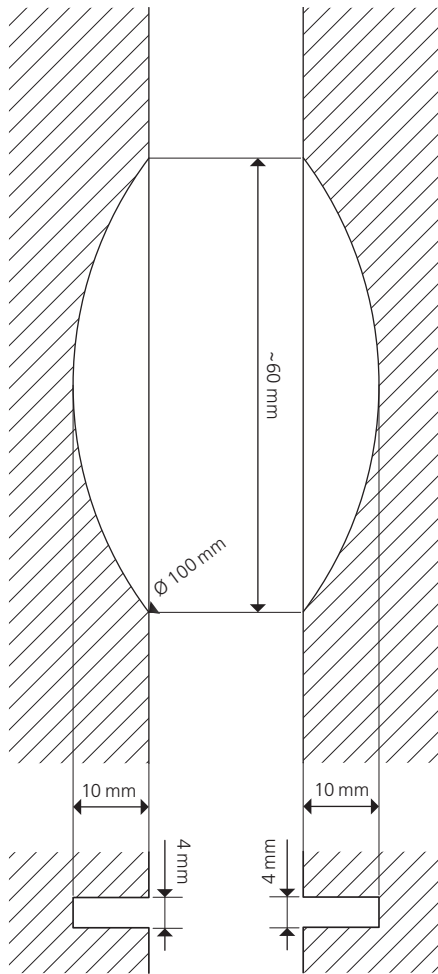
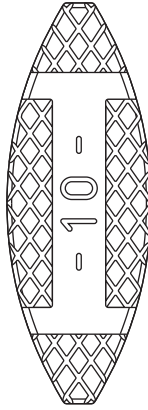

Abhängig vom Klebstoff
Depending on the adhesive

Original Holzlamelle 0 /
Original wood biscuit 0

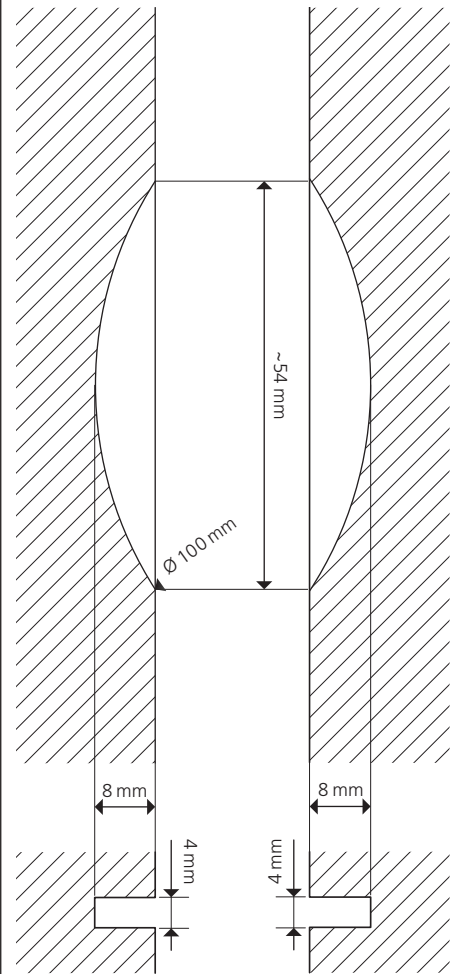
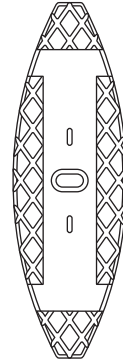

Abhängig vom Klebstoff
Depending on the adhesive

**Original Holzlamelle H9 /
Original wood biscuit H9**

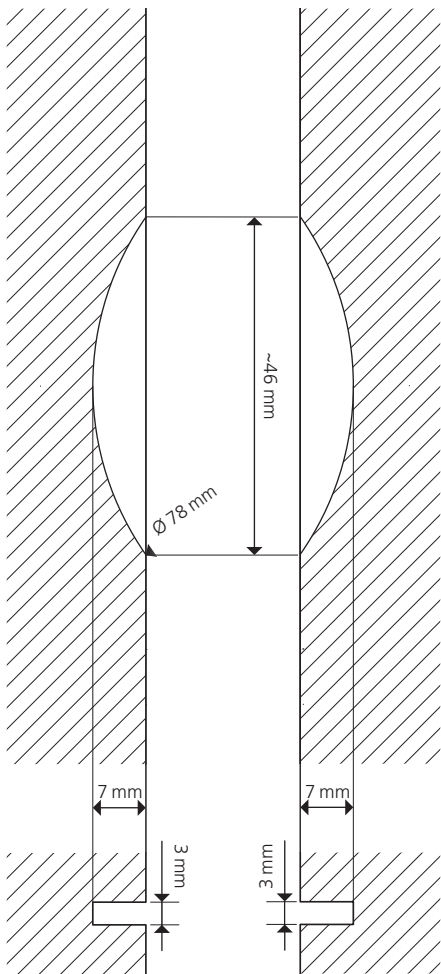

**Zugfestigkeit (N)
Tensile strength (N)**

Abhängig vom Klebstoff
Depending on the adhesive

C20

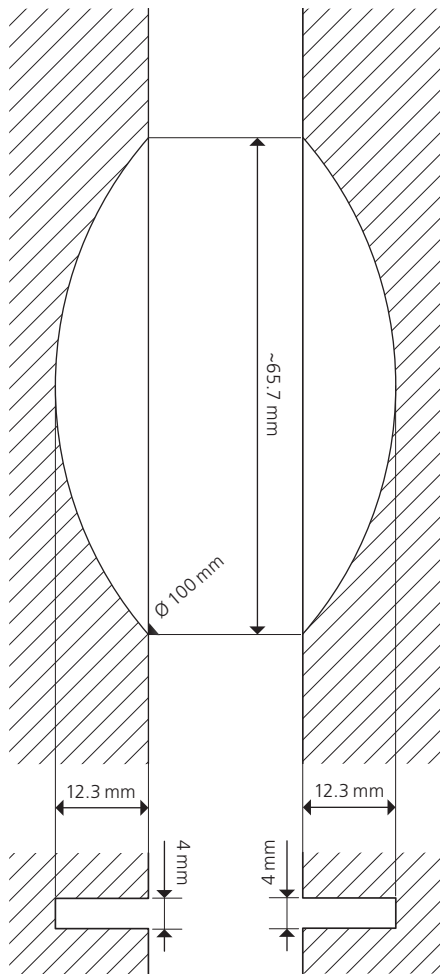
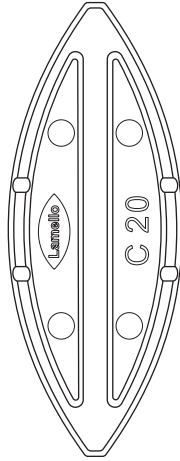

**Zugfestigkeit (N)
Tensile strength (N)**

Abhängig vom Klebstoff
Depending on the adhesive

C10

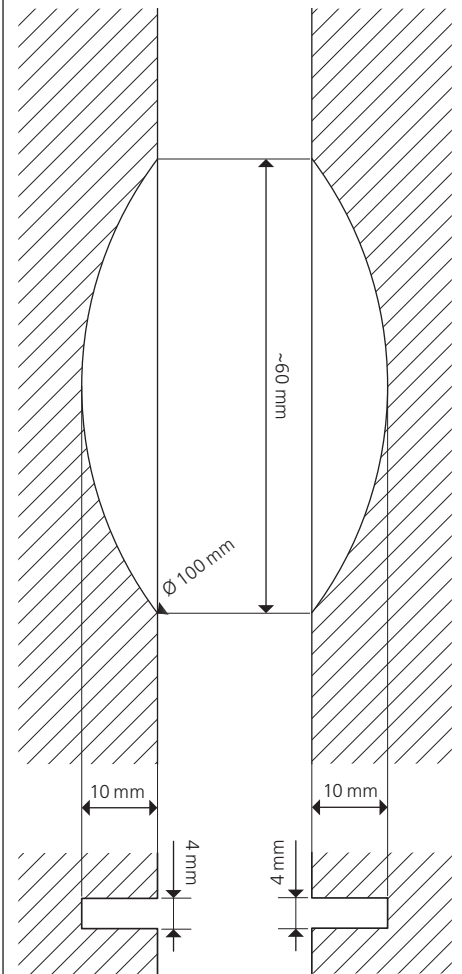
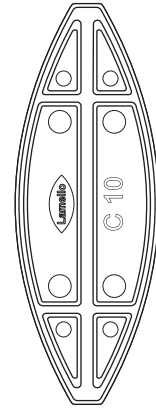

Abhängig vom Klebstoff
Depending on the adhesive

Clamex S-18

Simplex

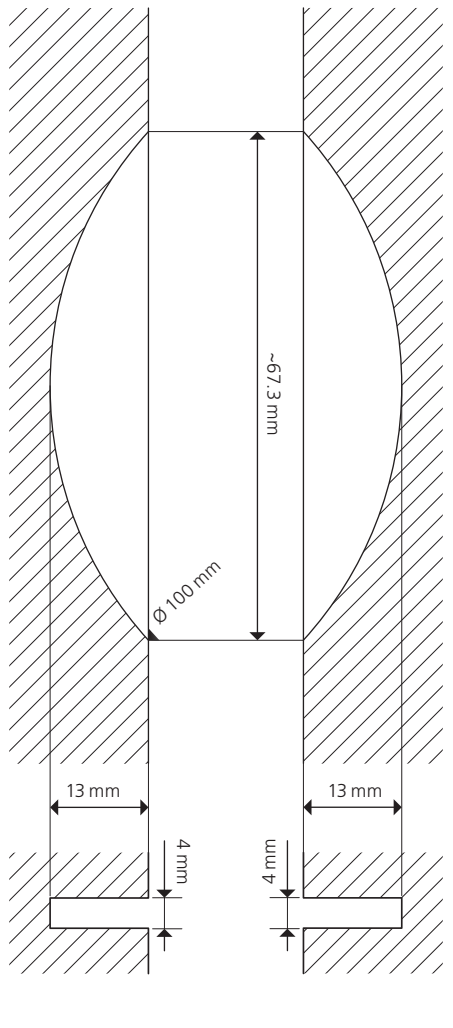
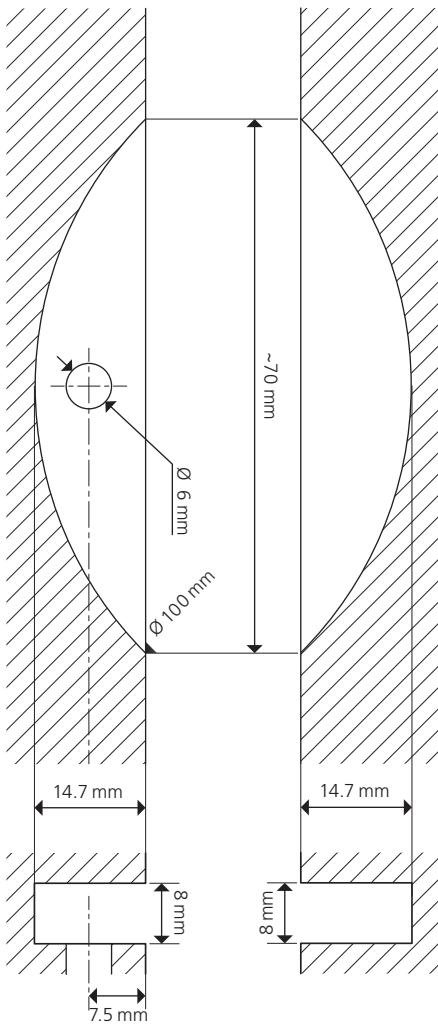
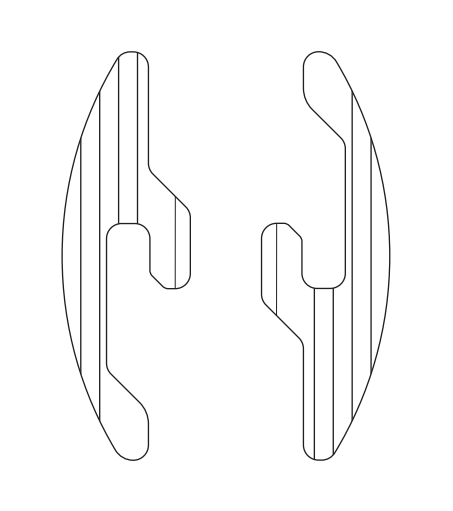
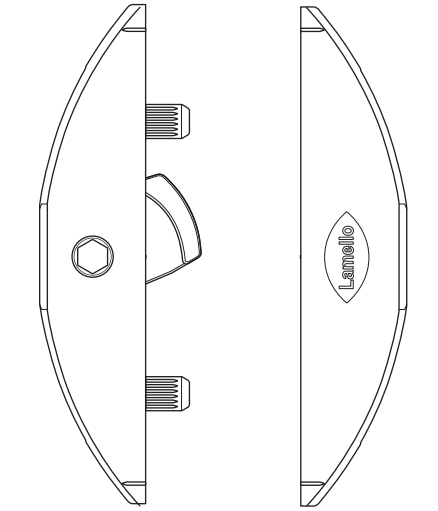

**Zugfestigkeit (N)
Tensile strength (N)**

Abhängig vom Klebstoff
Depending on the adhesive

Abhängig vom Klebstoff
Depending on the adhesive

K20

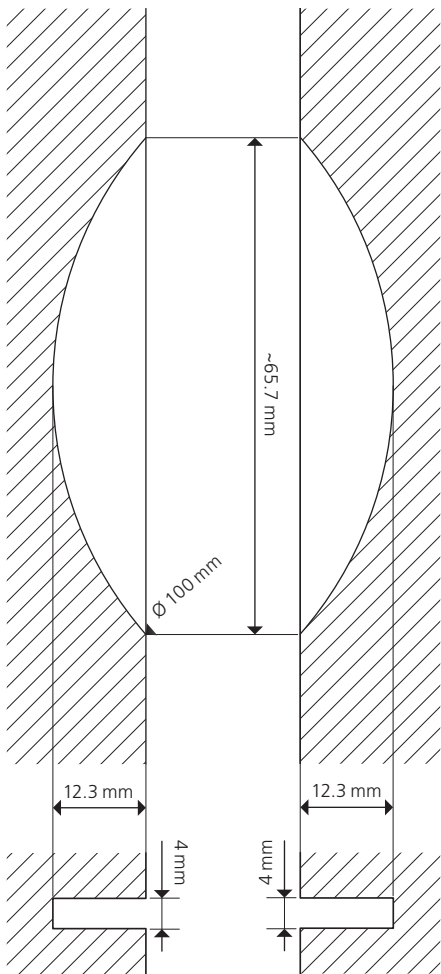
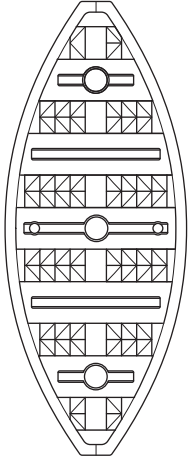

Zugfestigkeit (N)
Tensile strength (N)

Abhängig vom Klebstoff
Depending on the adhesive

E20-H

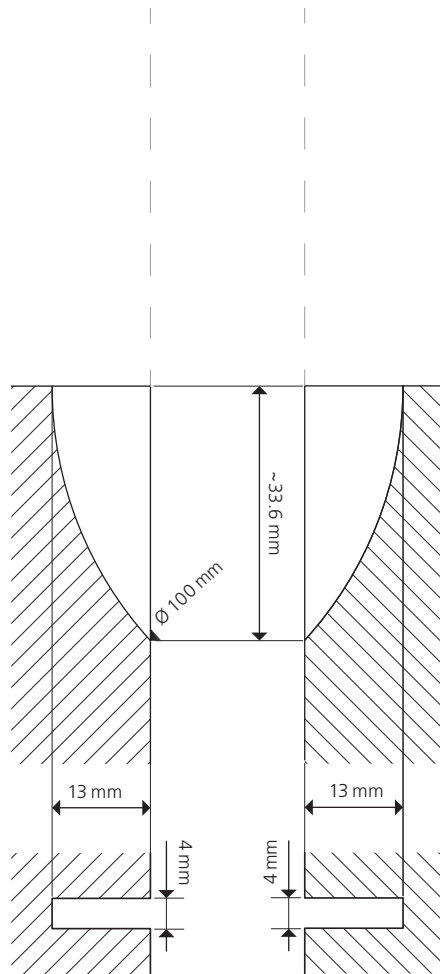
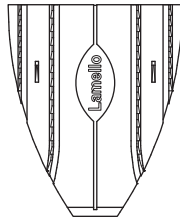

Zugfestigkeit (N)
Tensile strength (N)

Abhängig vom Klebstoff
Depending on the adhesive

E20-L

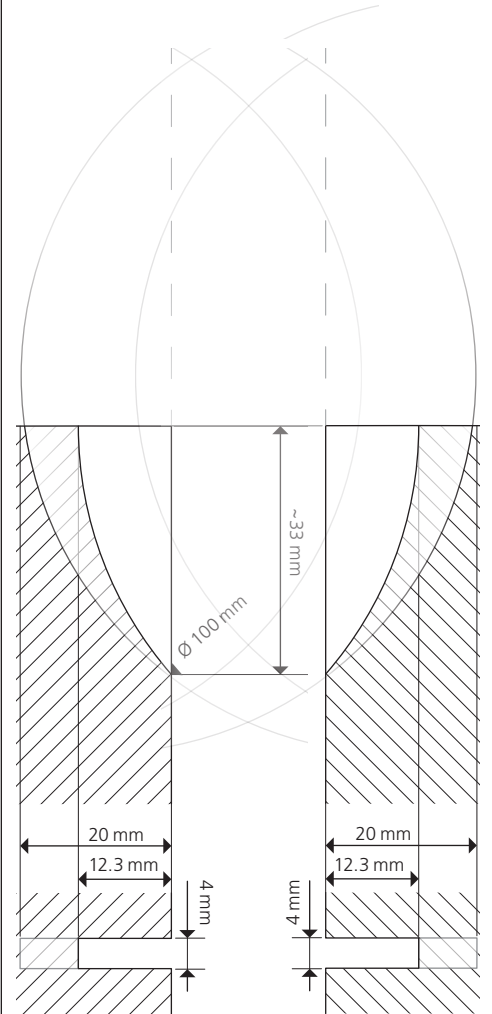

Abhängig vom Klebstoff